

DANCOVER[®]



Manual for
SEMI PRO PLUS
Inner linings

How to attach SEMI PRO PLUS inner lining:

1. Assemble your marquee roof.
2. Start by attaching marquee leg poles on one side of the marquee (note: one side only as this will enable you to reach the inner lining attachment points).
3. Put on and attach the marquee roof cover.
4. Start attaching your inner lining. Begin by attaching the centre of the inner lining to the centre of roof purlin (see drawing). Close click buckles around pole connectors and tie the middle string. Then attach the inner lining to the end of the roof purlin (see drawing). Finally attach the sides of the inner lining to the sides of the marquee.

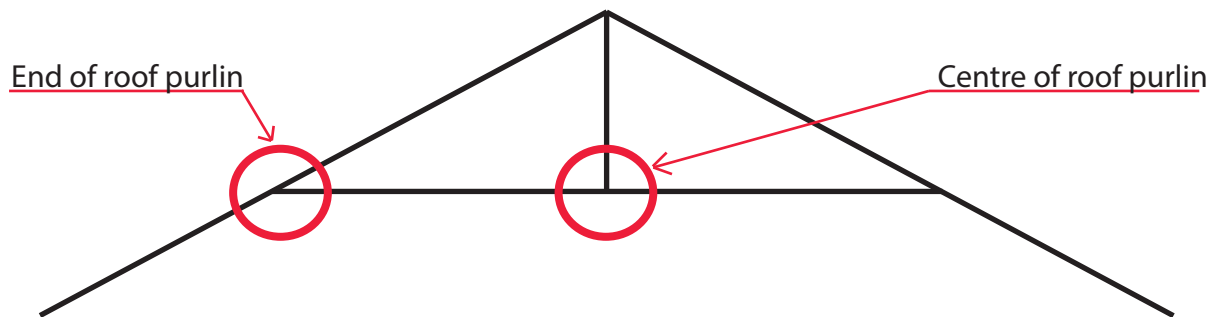

5. Once your inner lining is attached, put on the rest of your marquee leg poles.
6. Then attach the marquee sidewalls & endwalls (if you want them on your marquee).
7. End by attaching the leg curtains which match the inner linings.

Contact information

Head office:

Dancover A/S
Nordre Strandvej 119 G
3150 Hellebæk
Denmark

For more information
please visit:
www.dancovershop.com

National contact

Denmark:

denmark@dancover.com

UK:

uk@dancover.com

Germany:

germany@dancover.com

France:

france@dancover.com

Sweden:

sverige@dancover.com

Finland:

suomi@dancover.com

Poland:

polska@dancover.com

Luxembourg:

luxembourg@dancover.com

Spain:

espana@dancover.com

Italy:

italia@dancover.com

Switzerland:

schweiz@dancover.com

Austria:

austria@dancover.com

Norway:

norge@dancover.com

Nederland:

nederland@dancover.com

Ireland:

ireland@dancover.com

Belgium:

belgique@dancover.com